

HH905N Hi-Hat Stand <Discontinued>

Production since Jun. 2014

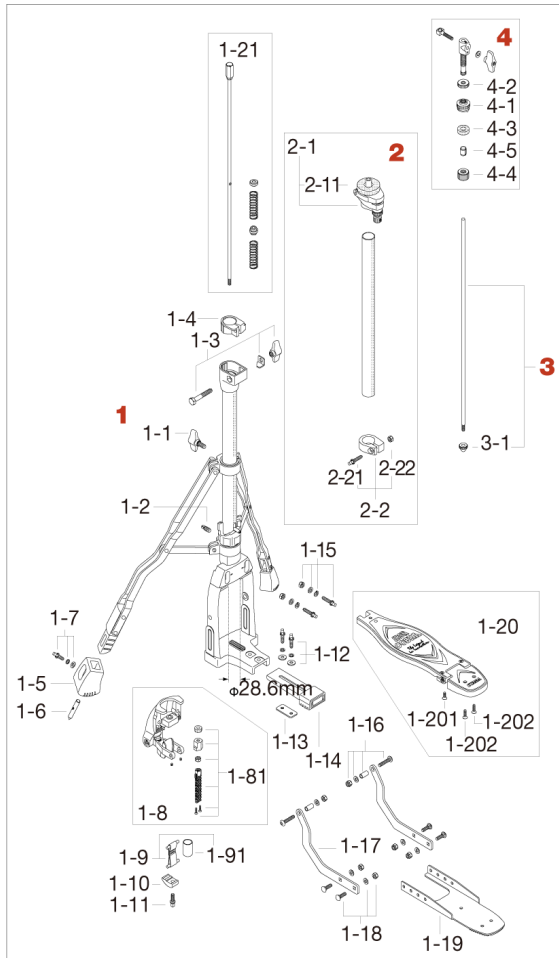

No.	Model No.	Description
1	HH905N1	Base assembly (LEVER GLIDE)
1-1	TS816P	T-bolt (M8x16mm, 2pcs/pack)
1-2	S812SH	Screw (M8x12mm)
1-3	HB850WN8L	Bolt (M8x50mm), L-plate, & nut assembly
1-4	NB2825	Nylon bushing (28.6mm-25.4mm)
1-5	RF-DS	Rubber tip
1-6	DSP56	Spike tip
1-7	MS615SHSW	Bolt (M6x15mm) & washers
1-8	HH905N110	Back plate w/ Lever Glide unit
1-81	HH905N112	Chain assembly
1-9	HH905-111	Strap w/ shafts & protective tube
1-91	NT905	Protective cover for strap
1-10	HP9-54F	Pressure casting
1-11	MS615SH	Square head bolt (M6x15mm)
1-12	MS620SHSW	Square head bolt (M6x20mm) & washers
1-13	HH905-116	Nut plate
1-14	HH905-117	Stabilizing plate w/ rubber cap
1-15	MS625SHNW	Bolt (M6x25mm), washers & nut
1-16	HH905-119	Bolt, washers, bushing & nut
1-17	HH905-120	Arm plate
1-18	B615ANT6WB	Bolt, washers & nut
1-19	HH905-124	Under plate only
1-20	HP908	Footboard assembly
1-201	S512	Screw (M5x12mm)
1-202	S516	Screw (M5x16mm)
1-21	HH905N126	Lower pull rod & spring assembly
2	HH905N2	Upper tube assembly w/Memory lock
2-1	SS15	Spring Seat
2-11	SS15FW	Felt washer
2-2	ML254N	Memory lock (25.4mm)
2-21	MS625SH	Square head bolt (M6x25mm)
2-22	NT6	Hex nut (M6)
3	HH905-3	Upper pull rod w/plastic nut (M6)
3-1	HH905-31	Plastic nut
4	SLC08*	Swing-lock clutch
4-1	SLC081	Swing-lock clutch nut
4-2	CL08-12	Lock nut
4-3	CL08-13P	Felt washer (2pcs/pack)
4-4	SLC084	Non-loose metal nut
4-5	SLC085	Collar

*SLC08 does not fit HH15-3(Rod for HH25W & HH15R).